



£144 Per Person Per Week

205 Clarendon Road, Leeds LS29DU

Apartment | 2 Bedrooms | 1 Bathroom

01132442443



www.samarahomes.co.uk



Step Inside

Key Features

- Available for 24/25 Academic Year
- All inclusive
- Prime location

Property Description

Property Ref: 72 SP BILLS INCLUDED- GAS, WATER, ELECTRICITY & COMPLEMENTARY WI-FI! MODERN-CLOSE TO UNIVERSITY- DONT MISS OUT! A modern apartment in a highly sought after location, directly opposite the School Of Chemical and Process Engineering. This two bedroom apartment is close to many local amenities such as shops, restaurants and take-aways and offers easy access to Headingley and the city centre via many bus routes.

Main Particulars

Property reference: 72 SP

- Directly opposite the University of Chemical and Process Engineering.
- Surrounded by several shops, restaurants and bars.
- High demand- early viewings are recommended!

This 2 bedroom property briefly compromises of a kitchen/living area equipt with a washing machine. There are 2 fully furnished, large double bedrooms each with a double bed, wardrobe, and desk with chair. Finally, there is a fully tiled bathroom, with a shower.

Other features include central heating and double glazed windows.

This property is priced at £144 per person per week, making the full rental amount £1,251.44 per calendar month. It is inclusive of gas, water, electricity and complimentary Wi-Fi.

*Please note all photos are a representation of the property, and viewing is required to see the exact layout and size.



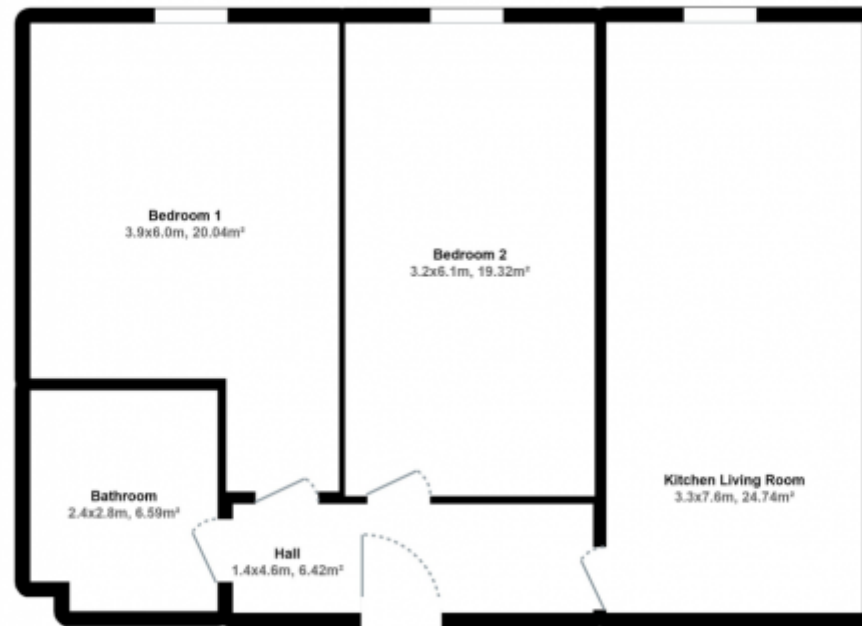

The provider and/or software owner gives NO guarantee in relation to layout or measurement accuracy of this floorplan and by using it, you accept full liability for any errors, omissions or inaccuracies.

72 SP

This floorplan is for illustrative purposes only and the location of doors, windows and other items are approximate.

Agents notes: All measurements are approximate and for general guidance only and whilst every attempt has been made to ensure accuracy, they must not be relied on. The fixtures, fittings and appliances referred to have not been tested and therefore no guarantee can be given that they are in working order. Internal photographs are reproduced for general information and it must not be inferred that any item shown is included with the property. Copyright © 2024 10078620 Registered Office: , 207 Clarendon Road LS2 9DU

Telephone: 01132442443



www.samarahomes.co.uk