



£124 Per Person Per Week

Woodsley Road, Leeds LS2 9LZ

Apartment | 2 Bedrooms | 1 Bathroom

01132442443



www.samarahomes.co.uk



Step Inside

Key Features

- Available for 24/25 Academic Year
- Prime Location
- Perfect for Students and Professionals
- Double Glazing

Property Description

Property reference: 158AWRF9 Well presented two bedroom flats located in a highly sought after area of Leeds 2, only two minutes walking distance from the University and Business School.

Main Particulars

Property reference: 158A WR F9

- Close proximity to the University of Leeds.
- Surrounded by several shops, restaurants and bars.
- Early viewings are recommended!

This 2 bedroom property briefly compromises of a fully fitted kitchen equipt with a washing machine, as well as a separate lounge area. There are 2 double bedrooms, both fully furnished with a double bed, wardrobe and desk with chair. Finally, there is a fully tiled bathroom with a shower.

Other features of this property include central heating and double-glazed windows.

This property is priced at £124 per person per week, making the full rental amount £1077.62 per calendar month. It is not inclusive of any bills.

*Please note all photos are a representation of the property, and viewing is required to see the exact layout and size.



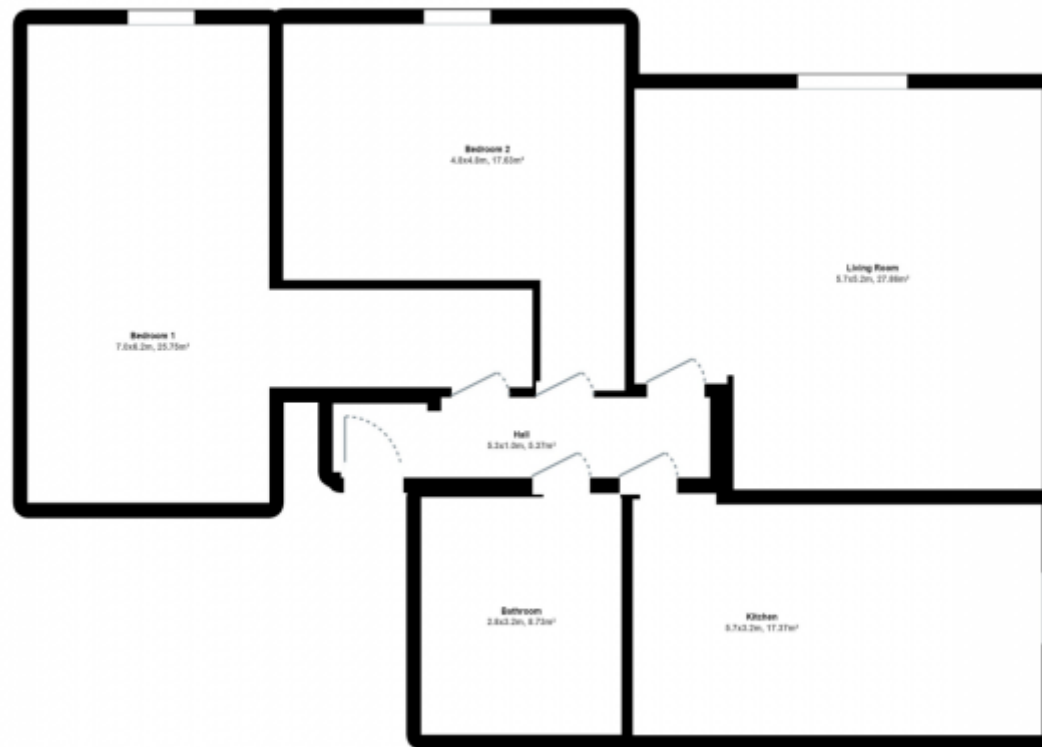

This floorplan is for illustrative purposes only and the location of doors, windows and other items are approximate.

Agents notes: All measurements are approximate and for general guidance only and whilst every attempt has been made to ensure accuracy, they must not be relied on. The fixtures, fittings and appliances referred to have not been tested and therefore no guarantee can be given that they are in working order. Internal photographs are reproduced for general information and it must not be inferred that any item shown is included with the property. Copyright © 2024 10078620 Registered Office: , 207 Clarendon Road LS2 9DU

Telephone: 01132442443



www.samarahomes.co.uk